

\* 2 year warranty on motor & pump only

**AIR COOLER**

# **AIROTRON SERIES**

Long lasting cooling

**EXTRA TALL  
DESERT MODELS**

**WIDER FAN &  
BLOWER FOR  
POWERFUL COOLING**

**LARGER COOLING PADS  
FOR ENHANCED COOLING  
EXPERIENCE**

Dear Customer,

Congratulations!! for being the proud owner of a V Guard Air Coolers. You have made an excellent choice and we hope you will enjoy all its specialities. This product comes to you from a company committed to total quality and dedicated to customer delight since 1977. Every V Guard Air Cooler is brought to you after an exhaustive and thorough series of testing procedures those cover every aspect of its functioning, performance and efficiency under varied operating conditions.

## TECHNICAL SPECIFICATIONS

Category	Desert Cooler				Room Cooler		Personal Cooler
Model Name	AIROTRON D115H	AIROTRON D90H / D90W	AIROTRON D75H / D75W	AIROTRON D50H / D50W	AIROTRON W50HT / W50WT	AIROTRON R40H	AIROTRON P26H
Supply Voltage	230V,50Hz AC	230V,50Hz AC	230V,50Hz AC	230V,50Hz AC	230V,50Hz AC	230V,50Hz AC	230V,50Hz AC
Air Delivery (m <sup>3</sup> /h) <sup>#</sup>	3250	3250	3050	3050	2130	1130	1130
Room Size (Sqft). <sup>#</sup>	300-350	300-350 / 300-315	290-334 / 250-300	290-334 / 250-300	200-250 / 180-225	100-133	100-133
Power Consumption in Watts	260	260	200	200	260	140	140
Speed Levels	3	3	3	3	3	3	3
Air Deflection	4 Way	4 Way	4 Way	4 Way	4 Way	4 Way	4 Way
Water Tank Capacity up to brim in Liters	115	90	75	50	50	40	26
Cooling Media	Honeycomb / Woodwool	Honeycomb / Woodwool	Honeycomb / Woodwool	Honeycomb / Woodwool	Honeycomb / Woodwool	Honeycomb	Honeycomb
Dimensions (W x D x H) cm	64.1 x 47 x 139.7	64.1 x 47 x 127.5	60 x 46.7 x 122.2	60 x 46.7 x 110.6	64.5 x 56.1 x 101.1	46.7 x 35.5 x 95.8	46.7 x 35.5 x 81.8

<sup>#</sup>Standard height of room (H) is 10'. Total air Volume in the room that gets delivered every 2 minutes. <sup>#</sup>Air delivery is mentioned in cubic meter per hour.

- Safety** : Earthing is provided.
- Note** : All above mentioned Specifications are under standard test conditions & actual performance may vary as per usage conditions.
- : Design, Specifications & Aesthetics are subject to change without prior notice due to continuous development.
- : Don't use hard water or soap water, which may result in the low performance of the main motor/pump. We recommended to use clean water only.

# COOLER FEATURES

- **Aerodynamically balanced body**  
Provides stability to the product & sturdiness.
- **High standing desert models**  
The air coolers are designed to keep you comfortable by providing air blast at optimum height.
- **Tetra air flow cooling**  
For equilateral cool air flow to all directions & for more area of coverage.
- **Large cooling pad area**  
Better cooling due to large cooling pads area.
- **Himalayan pine wood wool cooling pads (In select models only)**  
For enhanced cooling effect.
- **Thicker honeycomb pads (In select models only)**  
Long lasting & anti fungal cellulose Honeycomb cooling pads.
- **Unidrip flow water distribution**  
To ensure proper wetting of cooling pads by uniform water distribution.
- **Best-in-class air delivery**  
To feel the blast of cool air up to the extreme end of room
- **Wide voltage working range (160V ~ 270V)** Product even runs on extreme input voltage conditions in Urban & rural areas.
- **Inverter compatible**  
Works on inverter also to provide uninterrupted cooling.
- **Larger fan blade & blower for powerful cooling**  
Large & powerful fan blade and blower for wider area cooling.
- **Corrosion resistant fan blades / blowers**  
To avoid rusting of fan blades, which will lead to unnecessary service calls.
- **Enhanced protection for main motor & pump**  
Safeguard provision against extreme usage conditions & malfunctioning.
- **Bigger tank capacity**  
Allows to store more water - uninterrupted cooling for longer hours.
- **Power cord winding provision**  
Helps to avoid damage to power cord and allows the gentle use of the same.
- **Water Inlet**  
Hassle-free water filling into the water tank.

# KNOW YOUR V-GUARD AIR COOLER

## AIROTRON D115H/ D90H/ D90W/ D75H/ D75W/ D50H / D50W

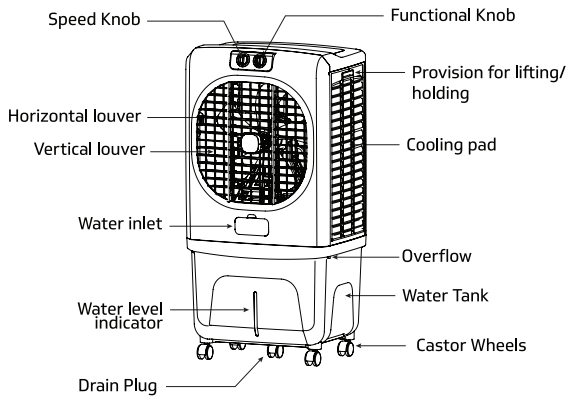

## AIROTRON W50HT/ W50WT

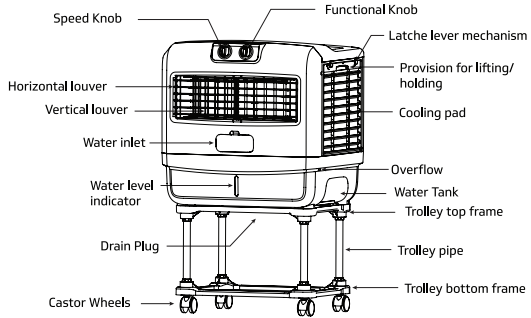

## AIROTRON R40 H

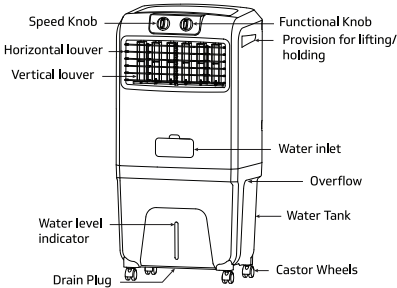

## AIROTRON P26 H

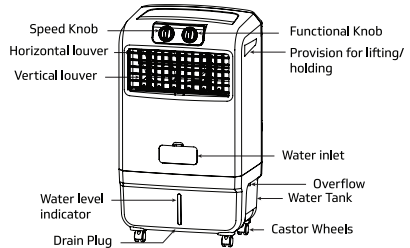

## WIRING DIAGRAM

### AIROTRON SERIES

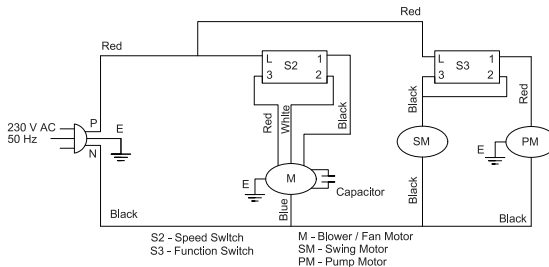

## APPLICATION

The Air cooler has been designed for placing on ground/floor inside the room, Please avoid direct exposure towards sunlight, rain, dust etc. You can enjoy the comfort, it provides where you need it most. Some of the applications to which V GUARD AIR COOLER can be adapted are.

Living Room • Dining Room • Offices • Restaurants • Bed Room • Kitchens • Clinics  
• Study Room • Shops • Balcony • Hotel Rooms • Outdoors

In fact, the applications of your V-GUARD AIR COOLER are limitless

# INSTALLATION

1. Air Cooler should be operated on a flat surface. Avoid placing it on inclined or irregular surfaces for better performance.
2. Place the Air Cooler at least 10 cm away from the wall or any other obstruction. The cooler should be placed near to window/door to allow intake of fresh air.
3. Always ensure that there is another open window / door through which warm air can exhaust from the room. Cross Ventilation is essential for getting the best results from your Air Cooler.
4. Plug in the mains cord of your Cooler to a wall socket. The Air cooler should be connected through shock protection devices, like ELCB and short circuit protection device like MCB.
5. While plug in the mains cord please ensure that phase (L) & neutral (N) of the mains cord should match with the phase and neutral of the socket as per standard.

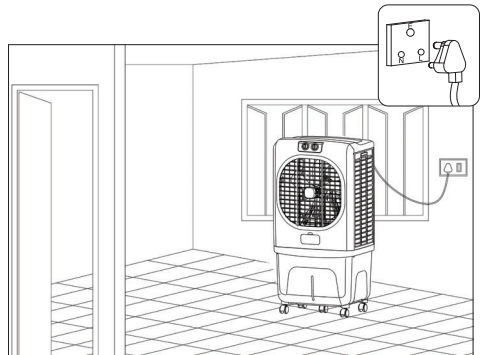
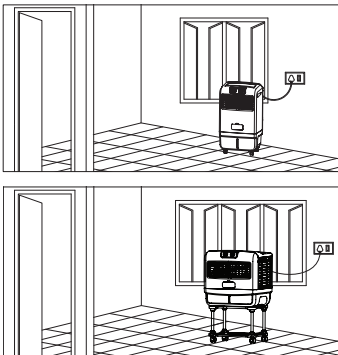

# OPERATIONS

1. Install the Cooler as per Installation procedure.
2. Filling of Water:

Just fill water tank (as per tank capacity) of your air cooler through the water inlet port. The water level indicator will show the water level in the tank. Don't fill the the water above tank capacity, if so overflow provision is provided. It is advisable to use tumbler to fill the water to ensure no spillage (Ensure the power point is OFF while filling water).

3. Power Supply:

Ensure that your Air cooler is plugged into specified Voltage & Frequency outlet only. Also ensure proper earthing of power point. Switch 'ON' the power supply.

WATER POURING - AIROTRON D115 H/D90 H/ D90 W/ D75 H/ D75 W/ D50 H / D50 W

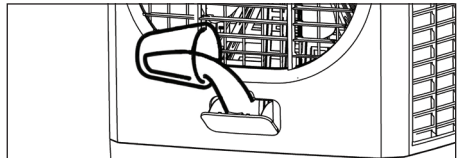

WATER POURING - AIROTRON W50 HT/ W50 WT

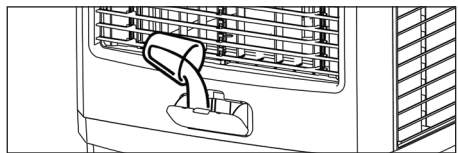

WATER POURING - AIROTRON R40 H/ P26 H

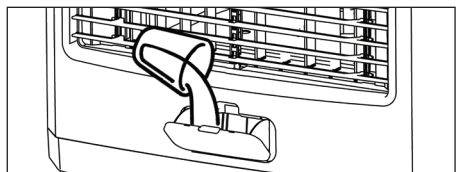

#### 4. Pre-Soaking:

Before turning ON Cooler fan, it is advisable to run pump for few minutes by rotating FUNCTION Knob "COOL/PUMP" mode, this will ensure uniform soaking of cooling pad & avoid sprinkling of water if any. Also, 2-3 drain cycles to be carried out on purchase of the air cooler to eliminate smell of honeycomb pads. For faster cooling adding ice cubes to water inlet is recommended.

#### 5. Panel removal / fixing:

##### A. Back panel for AIROTRON P26H:

Remove four thumb screws on back panel to separate the panel from the cooler. While fixing the back panel, position the bottom side first and then fix the thumb screws..

B. Side & Back panel for AIROTRON desert & room cooler - Bring the lever latch thumb provided on side panel to unlock position (Ref. Fig. A). Then remove the snaps of side panel carefully using the screwdriver wherever required (Ref. Fig. B). Push the side panel assembly from inside for easy removal and pull the back panel

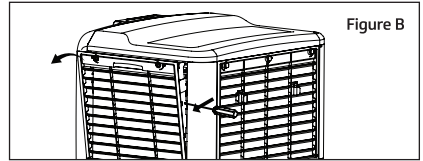
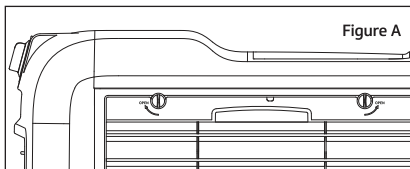

outward for removal, since side panel for AIROTRON desert coolers are screwed and not recommended for removal. While fixing the panels, position the bottom side first and push it towards the desired position. Keep the screw latches in the lock position after use.

#### 6. Better Performance:

For better air blast run the cooler on high speed. Run the cooler on low speed to get better cooling & low noise level.

#### 7. Controls:

- A. Set the SPEED Knob to desired level viz. WINDY, GENTLE, QUIET (i.e. High, med, low) of air delivery. To use the cooler in the COOL mode; Set the FUNCTION Knob to COOL/SWING position to obtain continuous horizontal oscillation of cool air.
- B. For a focused blast of cool air, wait for the blast to focus in the desired direction and then turn the FUNCTION Knob to COOL position.
- C. To use the cooler in FAN mode only; set the FUNCTION Knob to SWING position to obtain continuous horizontal oscillation of air.

## SAFETY PRECAUTIONS

- Always disconnect mains supply before filling water.
- Do not fill the water beyond over flow level.
- Do not try to fill the water into the cooler while in operation.
- Do not move the cooler rapidly when there is water in the tank.
- Always disconnect mains before opening cooling pads and panels.
- Be particular & careful when using the cooler near curtains. Keep safe distance from the curtains.
- Company is not responsible if any shock / injury occurred in case the Air Cooler is not connected through shock protection device like ELCB.
- Children must not be allowed to operate / play with cooler.
- An alternating current (AC supply) has the potential to induce an EMF in the motor casing. So, it's very important to ground the case with earthing via power cord.

# OPERATIONAL CARE AND REGULAR MAINTENANCE

## Operational Care

- When your Air Cooler is not in operation, make sure to switch **all** the switches to OFF position.
- Operate the Knobs gently.
- Close the water inlet of the air cooler after **filling** the water.
- Do not wipe the cooler with harsh chemicals, scrubbing powder or thinner as they will damage the body.
- Do not keep heavy load on the top of your Air Cooler.
- Do not add any bleaching agents/perfumes into the water in the tank as it may reduce cooling efficiency.
- Before moving or relocating the cooler, ensure mains cord is unplugged and water Tank is empty.
- Do not immerse the unit in water.
- Do not use any cleaning chemicals such as detergents and abrasives.

## Regular Maintenance

Periodic maintenance helps to keep your Air cooler in good condition.

- It is recommended to drain the Cooler and clean the cooling pads every month.
- Replace the HONEYCOMB PAD once in two / three years & replace the cooler pad once a year in case of WOOD WOOL.
- After the summer season, ensure that water is drained off completely & pads are dried before storage.

# TROUBLE SHOOTING

If Air cooler fails to operate, please check the following before calling for service.

Problem	Possible Cause	Solution
Air Cooler fails to operate/ No discharge of air	Power cord is not plugged in	Make sure that the power cord is plugged in & the supply switch is "ON".
	Power is not "ON"	Try to turn the unit ON by rotating the Speed Knob.
		Check electrical supply at power point and control panel.
	Speed switch is at OFF position	Ensure speed position is not in OFF.
	Motor faulty	Contact service centre
Not cooling/ Unit is making noise	Low or No water in tank	Refill water tank as per water level and tank capacity.
	Pump is not turning ON	Turn ON cool/pump function from control panel.
Odour from cooler	When the cooler is new	Cooling media will have an odour which will dissipate within a week of initial use.
	If the cooler has been used, there may be an algae issue	Replace water in the tank. Clean the cooling pad.

# GUIDELINES TO ASSEMBLE THE CASTER WHEELS IN AIR COOLER

एयर कूलर में कैस्टर व्हील फिट करने के लिए दिशानिर्देश |

## MODELS WITH 4 NUMBER OF WHEELS

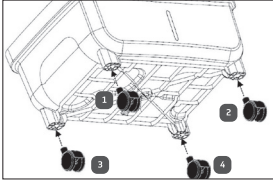

Wheel Fitment Sequence  
(Facing Tank Lens)

1. Front Left
2. Front Right
3. Back Left
4. Back Right

## MODELS WITH 5 NUMBER OF WHEELS

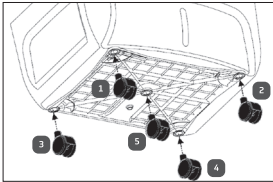

Wheel Fitment Sequence  
(Facing Tank Lens)

1. Front Left
2. Front Right
3. Back Left
4. Back Right
5. Tank Centre

- Press fit caster wheels into the wheel fitment holes provided on the tank as shown.  
पहियों को दिखाए गए चित्र के अनुसार टैंक के व्हील फिटमेंट होल में दबाकर बिठाना है।
- There is a possibility of the tank breaking and bending due to incorrect wheel fitment and not installing the middle wheel. It is mandatory to use centre wheel in air cooler with 5 no's wheels, with the other four wheels.  
पहियों के गलत फिटमेंट और बिच वाला व्हील नहीं लगाने पर टैंकी टूटने का और झुकना की संभावना होती है। 5 पहियों की संख्या वाले एयर कूलर में, बिच वाला पहिया अन्य चार पहियों के साथ लगाया जाना जरूरी है।
- Do not move the cooler rapidly when there is water in the tank.  
टैंकी में पानी होने पर कूलर को तेजी से न चलाएं।



V-Guard Industries Ltd.  
Registered Office:  
42/962, Vennala High School Road,  
Vennala, Kochi - 682028, Kerala, India.  
[www.vguard.in](http://www.vguard.in)

SCAN TO AVAIL THE  
**DIGITAL  
WARRANTY**  
BY REGISTERING YOUR  
PRODUCT ONLINE



V-Guard Care  
0120 485 0100  
1860 180 3000  
[customercare@vguard.in](mailto:customercare@vguard.in)  
☎ 9633503333



Plastic Waste **EPR** Registration Number: **BO-13-000-07-AAACV5492Q-22**